

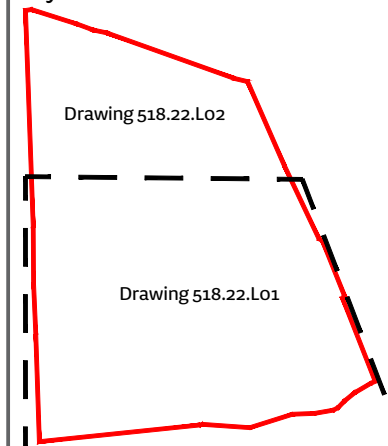

### Key Plan:



### Notes:

- To be read in conjunction with the most recent revisions of:
- Biodiversity Net Gain Feasibility Report by Red Kite
  - Tree Constraints and Arboricultural Impact Report Revision A (9<sup>th</sup> February 2022) by Red Kite
  - Drawing A\_00104 Phase 1 - Masterplan by bIT

Rev A Final issue for planning submission 09.04.24 KL NH

### CLIENT:

bIT

### PROJECT:

518.22 Newdale Pitches and Community Facilities

DRAWING: Soft Landscape Strategy Sheet 1

NUMBER: 518.22.L01 Rev A

DATE: February 2024

STATUS: Planning

DRAWN: KL

CHECKED: AM

Scale 1:1000 @ A3



Notes  
1. Do not scale from this drawing.  
2. All dimensions and setting out are subject to detailed design. Any discrepancies to be reported to Red Kite Network Limited immediately.  
3. If in any doubt, ask.  
4. This drawing and the works depicted are copyrighted and no duplication may be made without prior consent from Red Kite Network Limited.  
5. Not to be used for construction.

### SOFT LANDSCAPE STRATEGY LEGEND

- Individual tree planting to provide additional BNG habitat. This area of Telford is considered 'moderate' priority for tree planting; to increase the current 21% tree canopy cover to a goal of 30%. To be double staked for standard trees and triple staked for multi stem trees. Locations are subject to below ground services final positions. Refer to labels on this drawing for tree species size and schedule on drawing 518.22.L03 for suggested tree species list and specification.
- Proposed native blackthorn scrub planting to compensate for the loss of habitat, refer to the BNG report for additional information. Refer to schedule on drawing 518.22.L03 for suggested species and specification. To provide screening and habitat connectivity along the south and east boundaries.
- Proposed native hedge planting to provide +10% in BNG for linear features, refer to the BNG report for additional information. Refer to schedule on drawing 518.22.L03 for suggested species and specification.
- Proposed ornamental planting to car park area and new pavilion approach. Refer to schedule on drawing 518.22.L03 for suggested species and specification.

### SEEDING AND TURFING

- Wildflower seeding or turfing. To enhance the existing grassland habitat to provide a 'neutral grassland', refer to BNG report for additional information. Refer to labels on this drawing for seeding mix and turfing options. To be mown once annually.
- Amenity grass seeding. A seed mix to provide a suitable playing pitch grass surface and margins for amenity purposes. To be mown regularly.

### EXISTING LANDSCAPE FEATURES TO BE PROTECTED

- Existing tree group retained. Refer to Tree Constraints and Arboricultural Impact Report by Red Kite for further information including tree removal and tree protection.
- Existing individual tree retained. Refer to Tree Constraints and Arboricultural Impact Report by Red Kite for further information including tree removal and tree protection.
- Existing hedge retained.
- Existing grassland retained.

